

- **NOISE—AXLE—“WHINING” NOISE FROM REAR AXLE ON COASTDOWN FROM 97-56 KM/H (60-35 MPH)—VEHICLES EQUIPPED WITH 3.8L ENGINE ONLY**
- **AXLE—“WHINING” NOISE FROM REAR AXLE ON COASTDOWN FROM 97-56 KM/H (60-35 MPH)—VEHICLES EQUIPPED WITH 3.8L ENGINE ONLY**

**Article No.
00-23-1**

FORD: 1999-2001 MUSTANG

ISSUE

A “whining” noise may be heard from the rear on some vehicles during coastdown from 97 to 56 km/h (60 to 35 mph). This noise will disappear when the vehicle slows down below 56 km/h (35 mph). The noise may be caused by variation in tooth contact between the differential ring gear, pinion, and by the inability of the original upper control arm bushings to isolate the noise.

ACTION

Replace the rear axle and control arms with Service Kit YR3Z-4B490-BA. Refer to the following Service Procedure for details.

SERVICE PROCEDURE

Road test the vehicle with the customer to verify the condition, which may require several kilometers/miles of highway driving to thoroughly warm up the axle.

NOTE

DO NOT PERFORM THIS SERVICE PROCEDURE ON A VEHICLE THAT DOES NOT EXHIBIT THE DESCRIBED CONDITION.

REMOVAL

1. Raise the vehicle on a hoist. Using the appropriate year Mustang Workshop Manual, Section 205-02A, remove the rear axle assembly from the vehicle. (Do not remove the driveshaft from the transmission.) Refer to Figure 1.
2. Remove the two (2) upper control arms from the vehicle. Discard the (4) bolts, nuts, and arms. (New torque-to-yield bolts and nuts are provided in this kit.)

INSTALLATION

NOTE

THE UPPER CONTROL ARM BUSHINGS MUST BE NEUTRALIZED TO PREVENT PREMATURE WEAR OF THE BUSHINGS AND EXCESSIVE TRANSFER OF AXLE NOISE INTO THE VEHICLE.

1. Install the (2) upper control arms provided in this kit. Do not tighten the bolts at this time.
2. Follow the appropriate year Mustang Workshop Manual, Section 205-02A, and install the axle assembly provided in this kit. (Use new torque-to-yield bolts and nuts provided in this kit.) Do not tighten the rear lower control arm bolts at this time.

NOTE

IF THE DRIVESHAFT WAS REMOVED FROM THE TRANSMISSION, ENSURE THAT THE YELLOW DOT AT THE FRONT OF THE DRIVESHAFT IS ALIGNED WITH THE DOT AT THE END OF THE TRANSMISSION OUTPUT SHAFT DURING REASSEMBLY.

3. Install the driveshaft to the axle making sure that the yellow dot on the driveshaft is in alignment with the yellow dot on the axle flange. Torque driveshaft bolts to 112 N•m (83 lb-ft).
4. Install the new axle vent supplied in this kit.
5. Transfer and reinstall the clevis and brake adapter brackets.
6. Torque clevis bracket nut to 108 N•m (80 lb-ft).
7. Torque brake adapter bracket nut to 35 N•m (26 lb-ft).

Index • 054272

Article No. 00-23-1 Cont'd.

8. Install the upper control arm-to-axle bushing bolts. Do not tighten the bolts at this time.

NEUTRALIZING CONTROL ARM BUSHINGS

1. With vehicle still on hoist, place a tall screw-type jack stand at the front of vehicle under the front crossmember just below the steering gear. Adjust stand to make contact with the crossmember. Do not raise vehicle with the jack stand. Refer to Figure 1.
2. Use an automatic transmission jack to raise the axle assembly as far as possible without raising the vehicle off the hoist. Refer to Figure 1.
3. Torque the two (2) upper control arm-to-FRAME bolts to 90 N•m (66 lb-ft). Refer to Figure 2.
4. Torque the two (2) upper control arm-to-AXLE bolts to 103 N•m (76 lb-ft). Refer to Figure 2.
5. Torque the two (2) rear lower control arm bolts to 150 N•m (111 lb-ft) Refer to Figure 3.
6. Torque the rear brake caliper bolts to 103 N•m (76 lb-ft). Refer to Figure 4.
7. Check the axle fluid level; add fluid as necessary.

8. Remove jacks and lower vehicle to ground.
9. Road test vehicle and verify the repair.

Parts included in Service Kit YR3Z-4B490-BA:

- 8.8" Rear Axle Assembly
- Two (2) Upper Control Arms
- Sixteen (16) Nuts and Bolts
- One (1) Axle Vent
- One (1) Instruction Sheet

PART NUMBER	PART NAME
YR3Z-4B490-BA	Rear Axle Service Kit

OTHER APPLICABLE ARTICLES: NONE

WARRANTY STATUS: Eligible Under The Provisions Of Bumper To Bumper Warranty Coverage

OPERATION	DESCRIPTION	TIME
002301A	Replace Rear Axle And Control Arms	3.2 Hrs.

DEALER CODING

BASIC PART NO.	CONDITION CODE
4001	42
OASIS CODES: 509000, 597997, 702000, 702200, 702300	

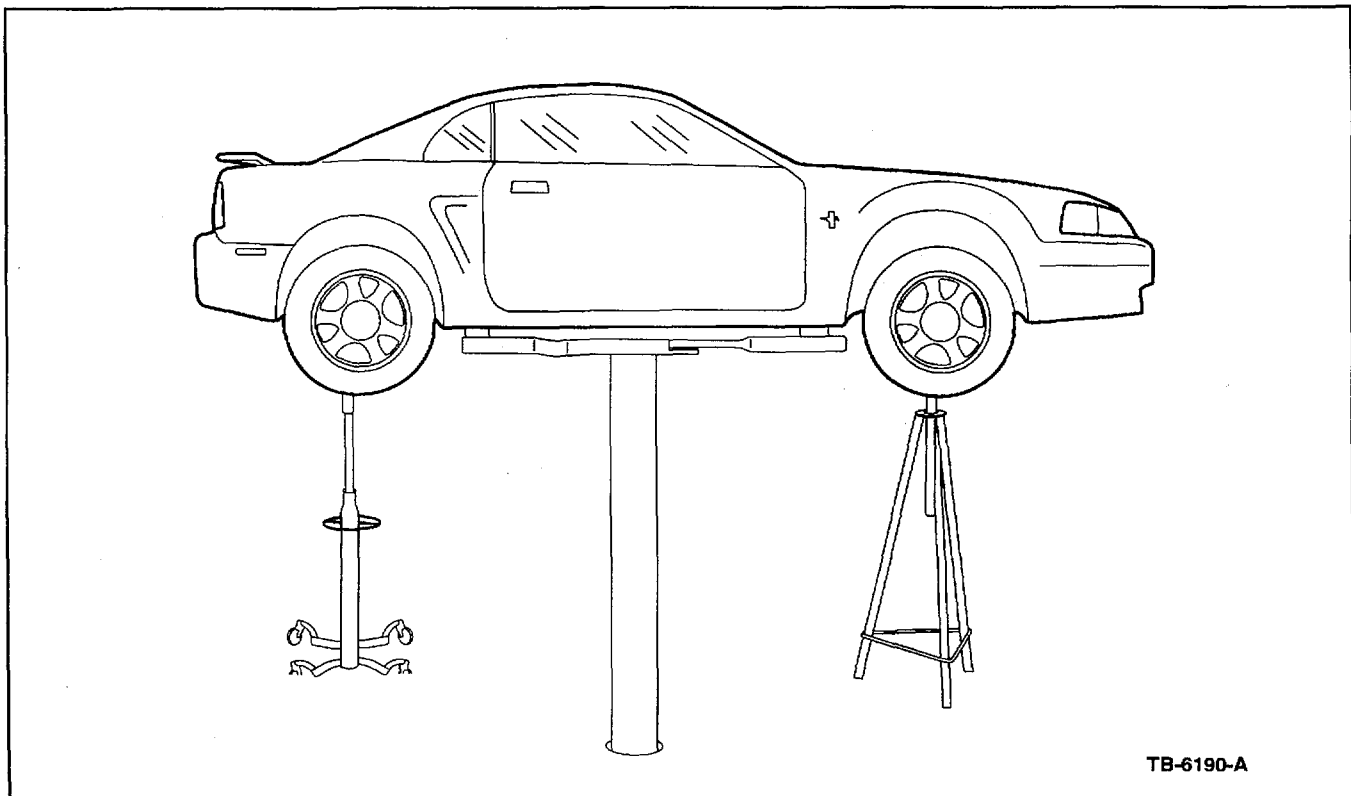

TB-6190-A

Figure 1 - Article 00-23-1

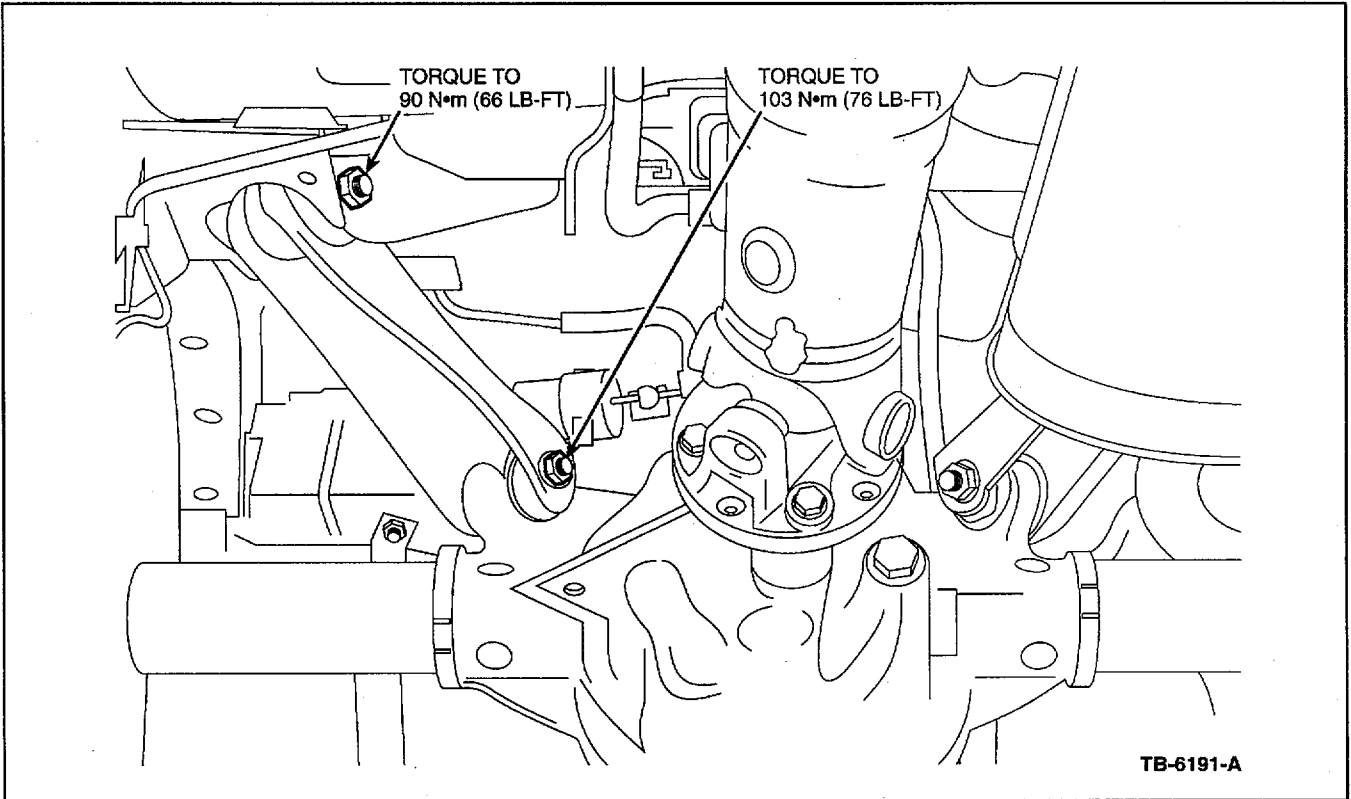

Figure 2 - Article 00-23-1

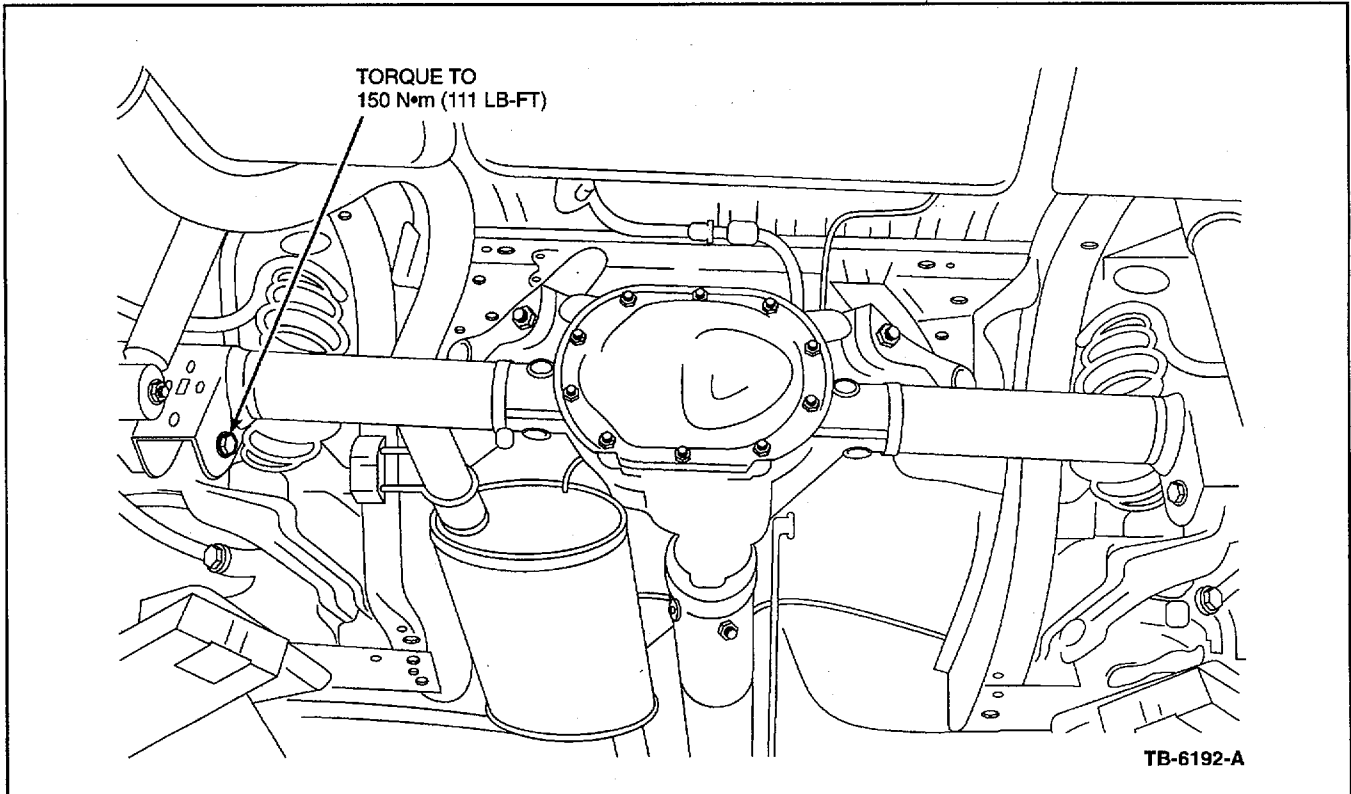

Figure 3 - Article 00-23-1

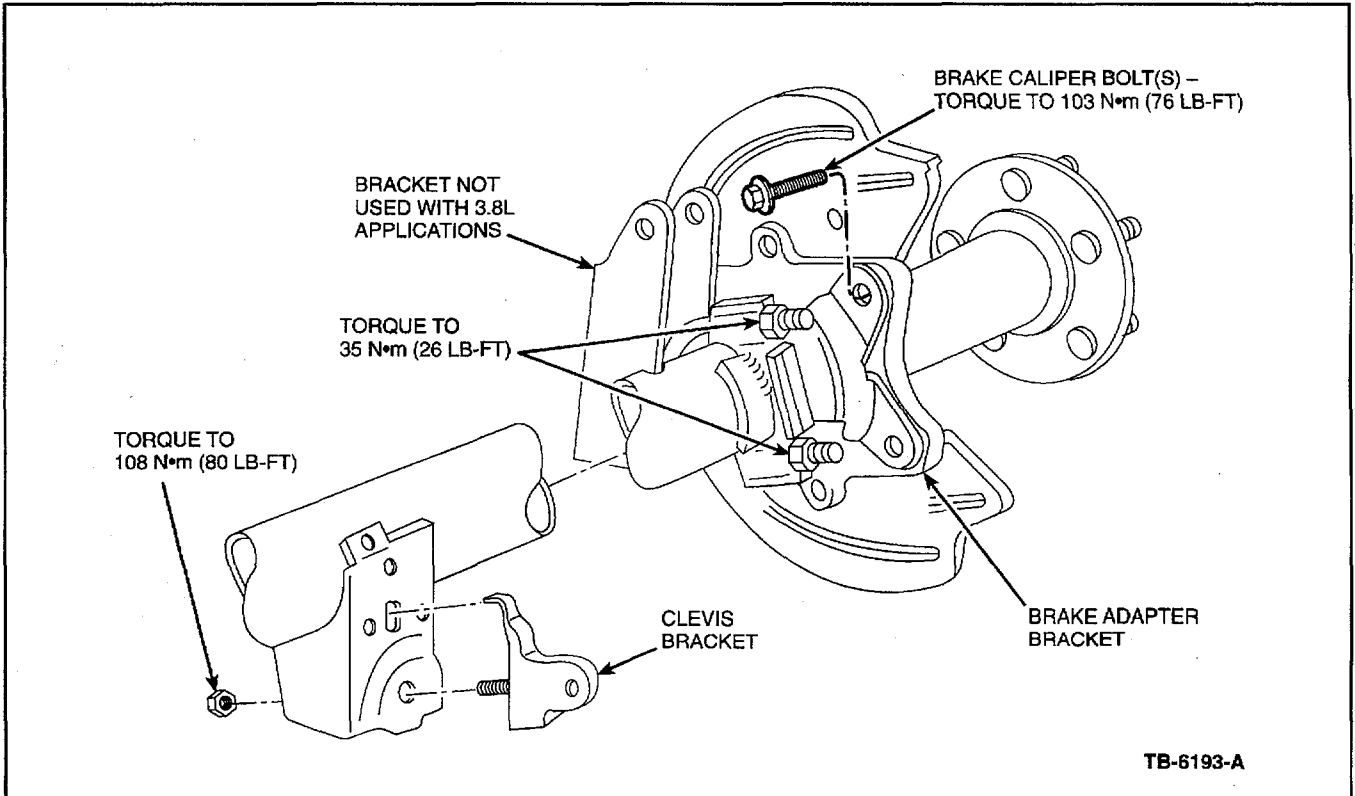

Figure 4 - Article 00-23-1